

MERIDIAN®

The Beaver Meridian® is a high capacity machine with a futuristic appeal that demands attention. It is constructed using die cast metal components with a durable powder coated finish, triple chrome plated die cast metal base, lid, chute assembly and New Generation coin mechanism. It also has a choice of different vending conversions and a high capacity shatterproof polycarbonate globe. The high capacity cash bag system, which is concealed at the back of the machine, is secured within the cast metal stand flanks and accessed by sliding up the aluminum cast cover plate. The Meridian is available in three unique colors and has many service friendly standard features.

Standard Features and Benefits

Globe: Shatterproof polycarbonate

Lock and Key: Tubular lock on lid

Design: Futuristic upscale design for all locations

Dispensing Conversions: 14 different merchandise conversions to vend bulk candy, nuts, gum or capsules

Coin Mechanism: New Generation triple-chrome plated single coin mechanism, easily accessed and removed

Cash Bag System: A high security and coin capacity system, which allows quick and easy service to the cash bag

Cash Bag System:

Chute: Straight drop through product chute

Colors: Available in red, blue or yellow

Safety & Security

Non-toxic lubricant on moving parts
Shatterproof globe



SPECIFICATIONS

Height:	55" / 1397mm
Width:	18" / 457mm
Depth:	18" / 457mm
Weight:	65lbs / 29kg
Capacity:	2000 pcs of 850 count gum

Service Steps:

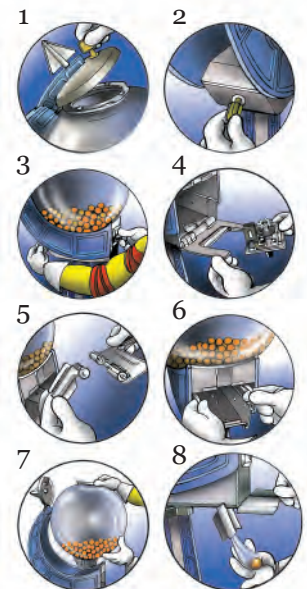

MERIDIAN COLOR CODE OPTIONS



Red

Blue

Yellow



The Triton® can be customized using a combination of Beaver's RB16, RB18 and RB23 series vending machines. This attractive display provides product variety and possesses the high quality standard found only in a Beaver product. The Triton is constructed using die cast powder coated parts and triple chrome plated accents including the stand base, machine bases, lids, hoppers, dispensing chute doors and coin mechanisms. The machine bodies are high impact ABS plastic and the globes are shatterproof polycarbonate. The sliding extended cash drawer option secures over 1100 quarters per unit and can lock using a different key than the one used to open the machines. This operator friendly feature allows access to the machine for refilling while not necessarily permitting access to the cash.

Standard Features and Benefits

Base: BS150 Stand

Machines: Includes a combination of three machines, choosing from the RB16, RB18 and RB23 complete with New Generation single coin mechanisms

Globe: Shatterproof polycarbonate

Coin Mechanism: New Generation triple chrome plated, all metal, 25 cent coin mechanism with penny hole back plate

Metal Parts: Triple chrome plated adaptor ring, base (without extended cash box option), hopper, lid, door and coin mechanism

Colour: **Stand:** Available in red, blue or yellow

Machine Body: Available in 9 great body colors in high impact ABS plastic that maintains color consistency when scratched

Lock and Key: Flat key geographically assigned for your security

Decal: Globe decal in USA, Canadian or Euro currency

Dispensing Conversion: Choice of merchandise dispensing conversions to vend products such as candy, nuts, gum, capsules, etc.

Mounting Hardware: Mounting plate and hardware included, with the ability to mount the machines as an island set up with access from all sides, or rotated with the coin mechanisms facing forward to place the unit in a corner or against the wall.

Safety & Security

Non-toxic lubricant on moving parts

Shatterproof globe

Chute cover protects products from foreign substances.



Triton



Triton
With Cash Drawer

SPECIFICATIONS	
Height:	56" / 1422mm
Width:	18" / 457mm
Depth:	18" / 457mm
Weight:	62lbs / 28kg
Capacity:	See RB section on Pg. 2 & 3

BS150 STAND COLOR CODE OPTIONS

-  Red
-  Blue
-  Yellow

See RB Series color codes for body colors



BEAVER MACHINE CORPORATION

1341 Kerrisdale Blvd.
Newmarket, Ontario
Canada L3Y 8Z8

e-mail: sales@beavervending.com
web: www.beavervending.com
U.S.A.: 1.800.265.6772
Int'l.: 1.905.836.4700
Fax: 1.905.836.4737



"Beaver sales
representatives are eager
to speak with you"